



WILTSHIRE

30X56 = 1680 SQ.FT.

This home plan ranges from \$250,000 and up. Personal selections will cause prices to change

This stunning home includes popular options: Hardie plank siding, third gable with double dormer, storm door, patio door, 9 Lite back door and Niagara front door, interior Clermont doors, etched pantry door, banks of drawers, skylight, recessed medicine cabinets, adjustable shelving, soft close hardware, oval tub, extended countertop, island work center, pull out trash/recycle bin, front door chimes, LED lights, pendant lights, stainless steel appliances, 5' shower, extra frost free tap, painted drywall interior, plywood floors, seismic upgrades, and optional windows.

Décor Choices:

Hardie Plank Siding: Aged Pewter with Aged Grey Shakes
Hardie Plank Trim: Pearl Grey
Roof: Dual Black
Interior Paint Color: Hearth

Cabinets: Chocolate Pear PVC
Backsplash: Solitude
Countertop: Luna Frost High Definition Laminate
Lino: Barn Wood
Carpet: Walking Trail

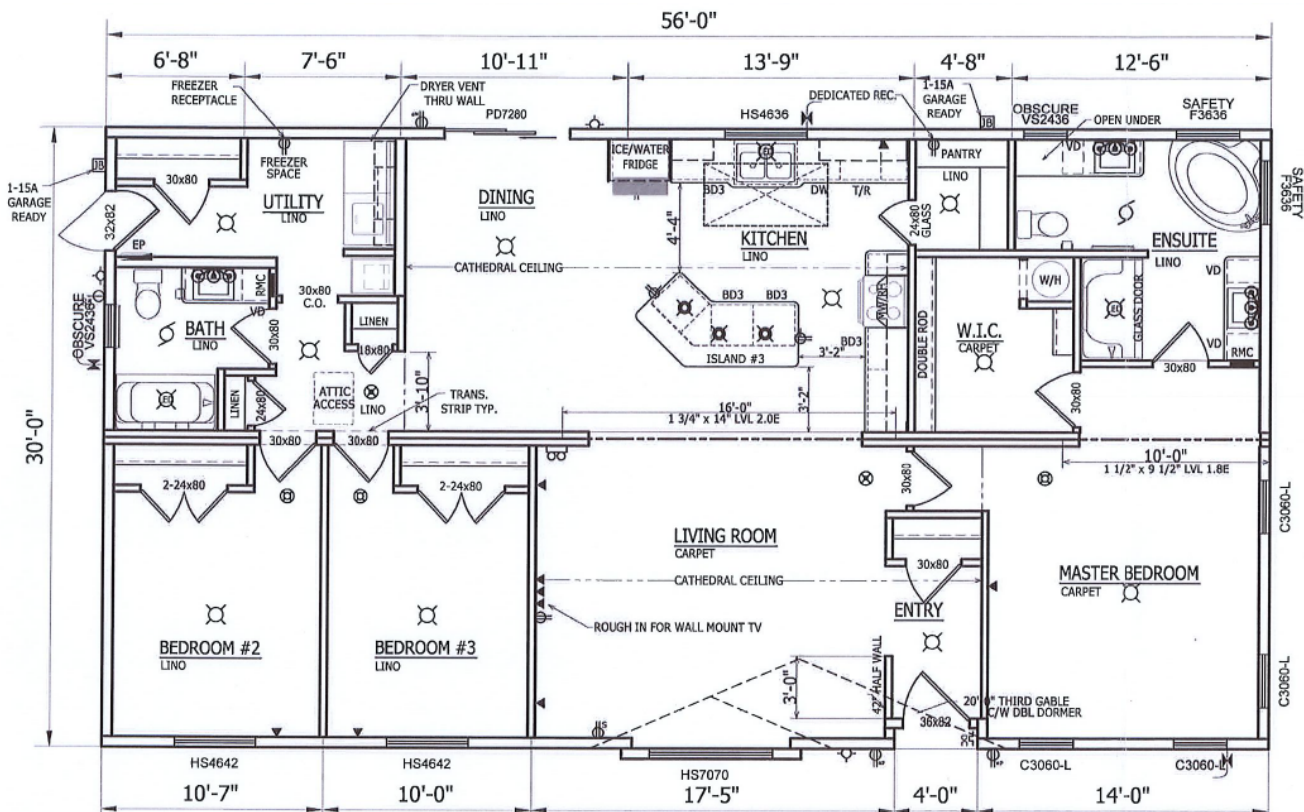

Price includes delivery and set up within delivery area. Additional charges apply outside of Port Alberni, Campbell River and Victoria.

Price subject to change without notice due to fluctuation in the lumber market

PH: 250-753-6223 Toll Free: 1-833-735-6225

www.gordonshomesales.com Email: info@gordonshomesales.com