

CHERRYVILLE

27X55 = 1282 SQ.FT.

This home plan ranges from \$259,300.00 and up. Personal selections will cause prices to change

This Cherryville is a sweet plan, complete with garage and is loaded with options, including: seismic upgrades, plywood floors, Harlow front door, storm door, recessed medicine cabinet, deep pots'n'pans drawers, lazy susan in the kitchen, glass in the upper corner cabinets, cookie sheet divider, a black silgranite sink with a Moen Align Spring Pull-Down faucet, extra GFI, extra frost free tap, 5' walk in shower in the ensuite, a 50" electric fireplace, painted interior drywall and stainless steel appliances.

Décor Choices:

Hardi color-plus siding: Iron Grey
Exterior Trim, Corner & Fascia: Navajo Beige
Roof: Charcoal Grey
Interior paint colour: Durum
Lino: DF9510

Vinyl Shakes: Treated Cedar
Cabinets: White with square pulls
Countertop: Ink Vesta
Backsplash: Biscuit
Carpet: Pewter Solid

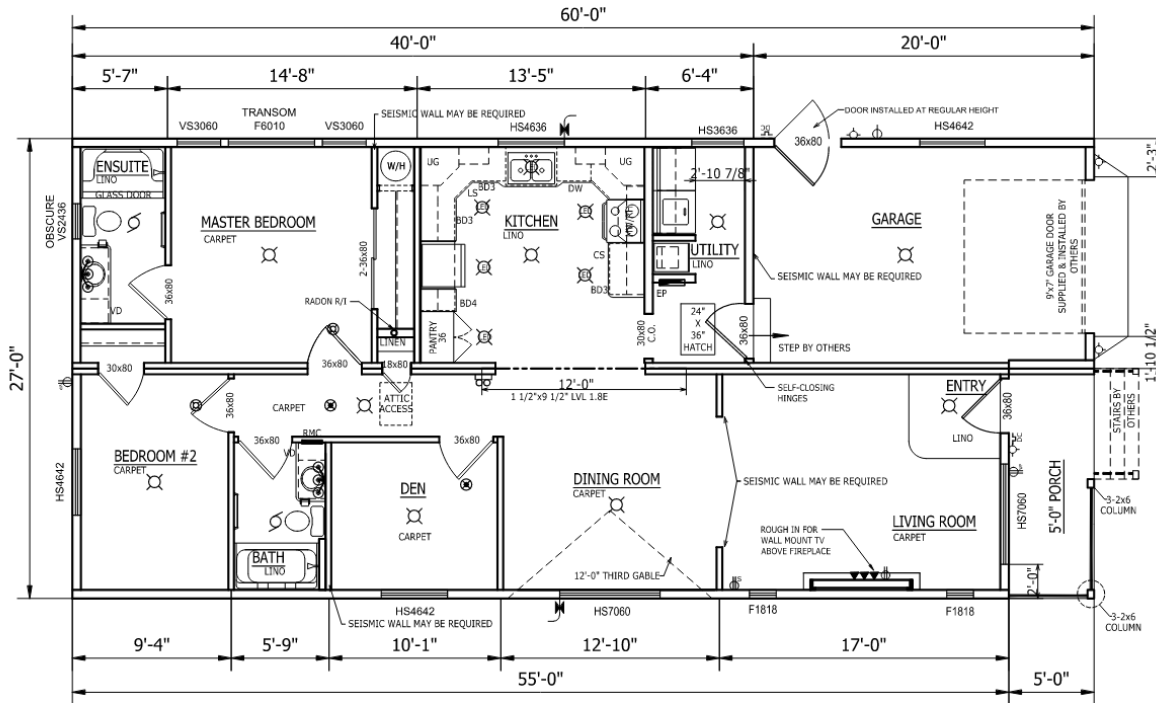

This home as presented is \$291,930 plus GST

Price includes delivery and set up within delivery area. Additional charges apply outside of Port Alberni, Campbell River and Victoria.

Price subject to change without notice
February 6, 2021